

# Haus A+C.

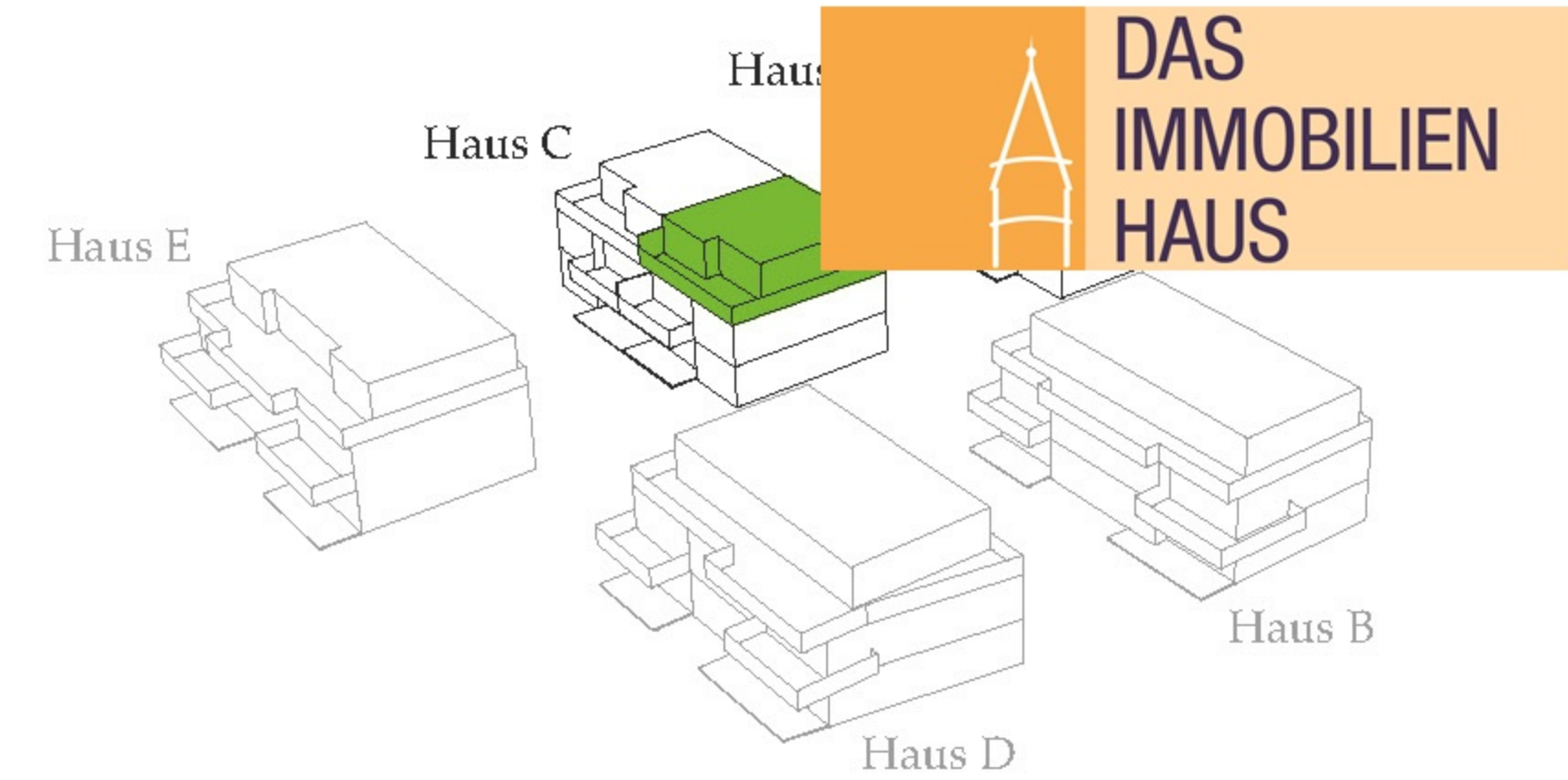

## Wohnung 6 | 2 Zimmer DG

Wohnen/Essen/Kochen	26,75 m <sup>2</sup>
Schlafen	14,87 m <sup>2</sup>
Bad	8,27 m <sup>2</sup>
Abstellraum	1,04 m <sup>2</sup>
Flur	5,27 m <sup>2</sup>
Dachterrasse (1/2)	13,46 m <sup>2</sup>
<b>Gesamt</b>	<b>69,66 m<sup>2</sup></b>

# Haus A+C.

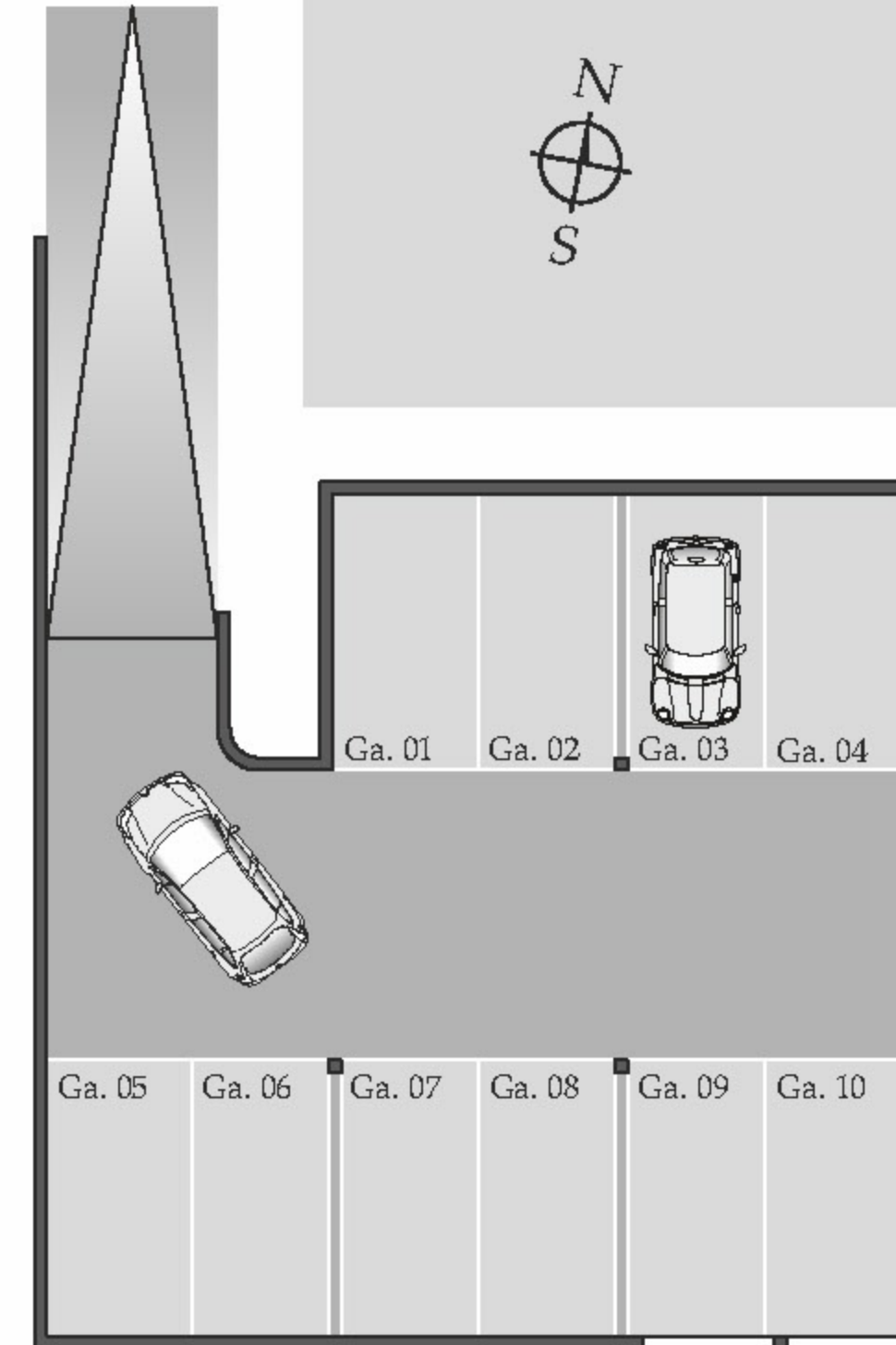
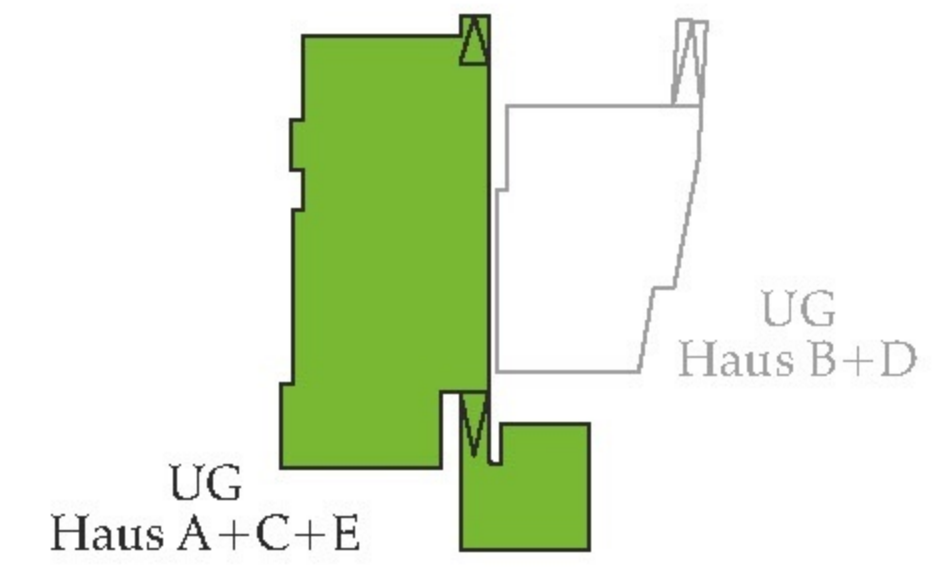

unverbindliche Illustration | nicht maßstäblich